

# DESALTO



## Stac

Giacomo Moor

The Stac containers family was created from the concept of offering different types of furniture with different functions, not by means of variations in size, but by stacking the elements. Each module is in fact made of a monolithic wooden volume, supported by a thin metal sheet that can be inserted into the module below, creating an open compartment and allowing stacking.

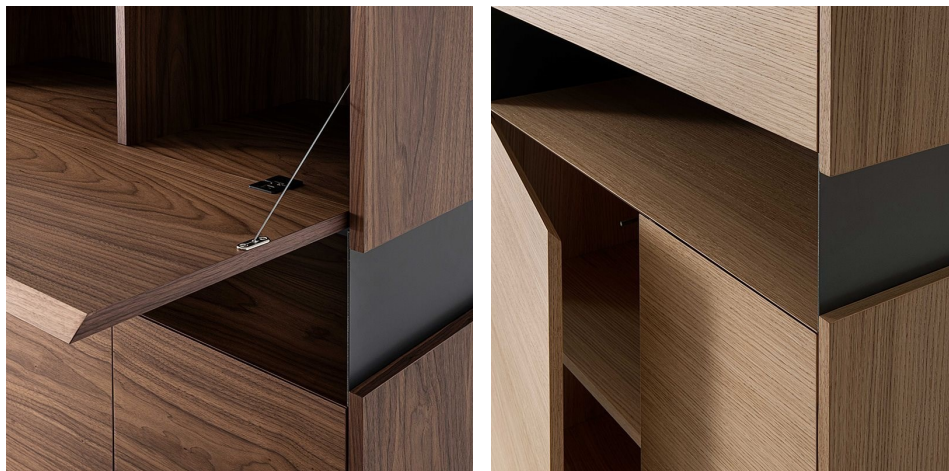

+61 8 9389 6669  
info@henriliving.com.au  
245 Stirling Hwy, Claremont WA 6010  
www.henriliving.com.au

Henri

## Available models

Wooden containers system with metal sheet structure.

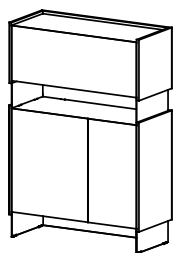

Stac

width 105 cm  
depth 45 cm  
height 155 cm

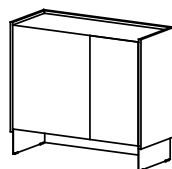

Stac

width 105 cm  
depth 45 cm  
height 95 cm

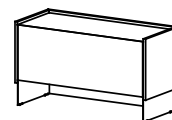

Stac

width 105 cm  
depth 45 cm  
height 60 cm

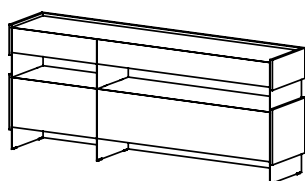

Stac

width 215 cm  
depth 45 cm  
height 90 cm

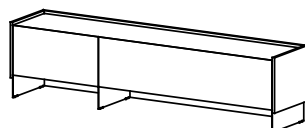

Stac

width 215 cm  
depth 45 cm  
height 54 cm

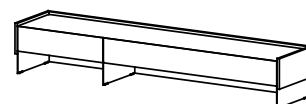

Stac

width 215 cm  
depth 45 cm  
height 36 cm

## Finishing

### Box

#### Wood



C88  
NATURAL  
OAK

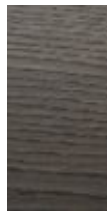

C76 OAK  
GRAFITE



C68 OAK  
MORO



C95  
WALNUT  
CANALETTO

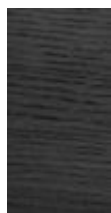

C14 OAK  
BLACK  
LACQUERED

### Steel sheet

#### Lacquers



B13  
SABBIA

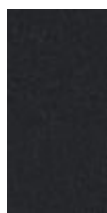

B42  
GRAFITE



B59 NERO  
OPACO



B62  
BIANCO  
OPACO

#### Metals



A74  
NATURAL  
IRON

